

Śruby dwustronne
Double end studs

DIN 2509

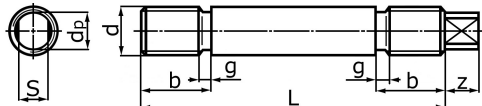

Wymiary wg DIN 2509
Dimensions according to DIN 2509

d	M12	M16	M20	M24	M27	M30	M33	M36	M39	M42
b short thread	21	25	30	36	38	42	44	50	52	57
b long thread	23	28	34	40	43	47	50	55	58	-
z	4	5	6	6	6	6	9	9	10	10
g	g = 3,5 P maximum									
S	7	10	11	11	13	13	22	22	24	24
d_p	8	12	14	14	18	18	25	25	28	28

d	M45	M48	M52	M56	M60	M64	M72x6	M80x6	M90x6	M100x6
b	58	64	68	73	76	82	89	95	103	111
z	11	11	12	13	14	14	15	15	15	15
g	g = 3,5 P maximum									
S	27	27	30	32	36	36	41	41	41	41
d_p	32	32	36	36	42	42	50	50	50	50

Śruby dwustronne do połączeń kołnierowych wykonujemy na zamówienie.
 Double end studs we make on order.



Śruby dwustronne
Double end studs

DIN 2510 L

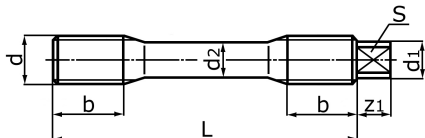

Wymiary wg DIN 2510 L
Dimensions according to DIN 2510 L

d	M12	M16	M20	M24	M27	M30	M33	M36	M39	M42
b	20	23	28	32	35	39	42	45	48	52
z ₁	4	5	6	6	6	6	9	9	10	10
S	7	10	11	11	13	13	22	22	24	24
d ₁	8	12	14	14	18	18	25	25	28	28
d ₂	8,5	12	15	18	20,5	23	25,5	27,5	30,5	32,5

d	M45	M48	M52
b	55	58	62
z ₁	11	11	12
S	27	27	30
d ₁	32	32	36
d ₂	35,5	37,5	41

Śruby dwustronne do połączeń kołnierzowych wykonujemy na zamówienie.
 Double end studs we make on order.

Śruby dwustronne
Double end studs

DIN 2510 K

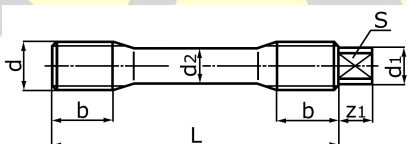

Wymiary wg DIN 2510 K
Dimensions according to DIN 2510 K

d	M12	M16	M20	M24	M27	M30	M33	M36	M39	M42
b	13	16	20	24	27	30	33	36	39	42
z ₁	4	5	6	6	6	6	9	9	10	10
S	7	10	11	11	13	13	22	22	24	24
d ₁	8	12	14	14	18	18	25	25	28	28
d ₂	8,5	12	15	18	20,5	23	25,5	27,5	30,5	32,5

d	M45	M48	M52	M56	M64	M72x6	M80x6	M90x6	M100x6	110x6
b	45	48	52	56	64	72	80	90	100	110
z ₁	11	11	12	13	14	15	15	15	15	15
S	27	27	30	32	36	41	41	41	41	41
d ₁	32	32	36	40	42	50	50	50	50	50
d ₂	35,5	37,5	41	44	51	58,5	66	75	84	92,5

Śruby dwustronne do połączeń kołnierzowych wykonujemy na zamówienie.
 Double end studs we make on order.

Śruby dwustronne Double end studs

DIN 2510 KU

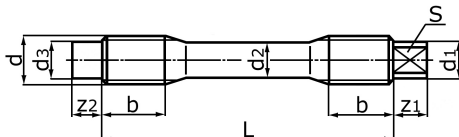

Wymiary wg DIN 2510 KU Dimensions according to DIN 2510 KU

d	M12	M16	M20	M24	M27	M30	M33	M36	M39	M42
b	13	16	20	24	27	30	33	36	39	42
z ₁	4	5	6	6	6	6	9	9	10	10
S	7	10	11	11	13	13	22	22	24	24
d ₁	8	12	14	14	18	18	25	25	28	28
d ₂	8,5	12	15	18	20,5	23	25,5	27,5	30,5	32,5
d ₃	8	12	13	16	18	21	24	26	30	32
z ₂	11	14	16	17	19	19	21	23	23	24

d	M45	M48	M52	M56	M64	M72x6	M80x6	M90x6	M100x6	110x6
b	45	48	52	56	64	72	80	90	100	110
z ₁	11	11	12	13	14	15	15	15	15	15
S	27	27	30	32	36	41	41	41	41	41
d ₁	32	32	36	40	42	50	50	50	50	50
d ₂	35,5	37,5	41	44	51	58,5	66	75	84	92,5
d ₃	34	37	40	45	52	56	63	74	86	97
z ₂	25	26	26	28	28	28	28	28	28	28

Śruby dwustronne do połączeń kołnierowych wykonujemy na zamówienie.
 Double end studs we make on order.

Śruby dwustronne Double end studs

DIN 2510 ZU

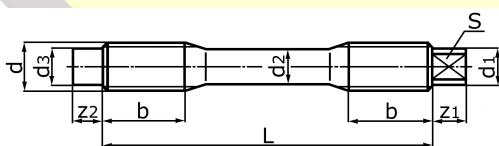

Wymiary wg DIN 2510 ZU Dimensions according to DIN 2510 ZU

d	M12	M16	M20	M24	M27	M30	M33	M36	M39	M42
b	27	31	36	42	47	50	53	57	60	64
z ₁	4	5	6	6	6	6	9	9	10	10
S	7	10	11	11	13	13	22	22	24	24
d ₁	8	12	14	14	18	18	25	25	28	28
d ₂	8,5	12	15	18	20,5	23	25,5	27,5	30,5	32,5
d ₃	8	12	13	16	18	21	24	26	30	32
z ₂	7	8	9	8	10	12	14	14	14	15

d	M45	M48	M52	M56	M64	M72x6	M80x6	M90x6	M100x6	110x6
b	66	70	74	79	88	95	103	112	122	132
z ₁	11	11	12	13	14	15	15	15	15	15
S	27	27	30	32	36	41	41	41	41	41
d ₁	32	32	36	40	42	50	50	50	50	50
d ₂	35,5	37,5	41	44	51	58,5	66	75	84	92,5
d ₃	34	37	40	45	52	56	63	74	86	97
z ₂	15	19	18	19	20	20	19	20	19	19

Śruby dwustronne do połączeń kołnierowych wykonujemy na zamówienie.
 Double end studs we make on order.

Śruby dwustronne
Double end studs

DIN 2510 Z

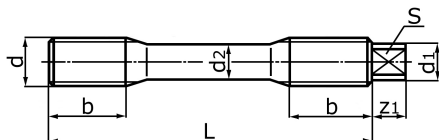

Wymiary wg DIN 2510 Z
Dimensions according to DIN 2510 Z

d	M12	M16	M20	M24	M27	M30	M33	M36	M39	M42
b	27	31	36	42	47	50	53	57	60	64
z ₁	4	5	6	6	6	6	9	9	10	10
S	7	10	11	11	13	13	22	22	24	24
d ₁	8	12	14	14	18	18	25	25	28	28
d ₂	8,5	12	15	18	20,5	23	25,5	27,5	30,5	32,5

d	M45	M48	M52	M56	M64	M72x6	M80x6	M90x6	M100x6	110x6
b	66	70	74	79	88	95	103	112	122	132
z ₁	11	11	12	13	14	15	15	15	15	15
S	27	27	30	32	36	41	41	41	41	41
d ₁	32	32	36	40	42	50	50	50	50	50
d ₂	35,5	37,5	41	44	51	58,5	66	75	84	92,5

Śruby dwustronne do połączeń kołnierowych wykonujemy na zamówienie.
 Double end studs we make on order.

